



ARCHITECTS
WITHOUT
FRONTIERS

2022–2023:

Transition Years for AWF

DESIGNING AND DELIVERING PROJECTS FOR AT RISK COMMUNITIES

ALC

Clarke
Hopkins
Clarke

HGA

H

hayball



LCI

NBRS*

SJB

Tract

WT

TRANSFORMING
LIVES THROUGH
DESIGN



“ You don’t often see sophisticated architects working on small scale development projects in disadvantaged communities, but what AWF have to offer in both contexts, is bringing a sense of good design to those who need it most. ”

THE HON GARETH EVANS QC,AO

CONTENTS

Message from the AWF Chair & Executive Director	3
Summary of Projects	5
- Local Projects	6
- International Projects	9
AWF Network Partners	15
Financial Report	16

FROM THE AWF CHAIR + EXECUTIVE DIRECTOR

2022–2023: CHALLENGES & OPPORTUNITIES

After a difficult 2020–2021, 2022 saw new projects commenced, existing projects continued, and several projects reach the end of delivery. AWF has positive plans in place for 2023 as we continue to design and deliver projects for at risk communities in Australia and around the world with the support of our large cohort of supporters and partners.

- **A community asset planning charrette** for Walhalla. (AWF with Tract Consulting)
- The **relocation of Vunivau village** in Fiji. (AWF with Hassell Studio),
- **Design proposals** for school kitchens and stores for the World Food Programme and the Royal Government of Bhutan. (AWF with Buro Architects)

These projects supplemented those existing:

- **Planning the accommodation wing** of the Cakaudrove Women's Resource Centre in Fiji. (AWF with AJC)
- **Interior fitout works** for the One Life to Love Home for Hope orphanage in India. (AWF with NBRS Architecture)

In addition to several projects reaching the end of delivery:

- **Building the Ejaad Women's Workshop, Training & Learning Centre in Afghanistan.** (AWF with SJB Architects)
- **Building the Carlton Neighbourhood Learning Centre indigenous garden.** (AWF with Tract Consulting)
- **Building the Good Samaritan Inn multi-purpose garden pavilion** (AWF with Hayball, LCI & WT Partnership)

WELCOME NEW PARTNERS

We are delighted to welcome two new Network Partners:

- **AJC Architects, Sydney** is a long-term partner and friend of AWF having worked together on many projects and exhibitions since 2006.
- **Harley Graham Architects (HGA) Byron Bay** becomes AWF's first regional Network Partner.



FROM THE AWF CHAIR + EXECUTIVE DIRECTOR

PARTNER EVENTS

AWF's Network Partner Event hosted by Hayball in October, celebrated our relationship with Hayball, LCI, Tract and WT Partnership on Stages 1 and 2 of the Good Samaritan Inn project.

AWF PARTNERS & COLLABORATIONS

AUSSIE ACTION ABROAD & THE ANGANWADI PROJECT

We extend our sincere thanks to our partners, Aussie Action Abroad (AAA) and The Anganwadi Project (TAP) whose continued design/build focus in Nepal and India has enabled AWF to provide ongoing support for communities in those regions.



AWF INTO 2023

AWF has positive plans in place for 2023 as we continue to design and deliver projects for at risk communities in Australia and around the world with the support of our large cohort of supporters and partners.

Phillip Greenham
AWF Chair

Esther Charlesworth AM
AWF Executive Director

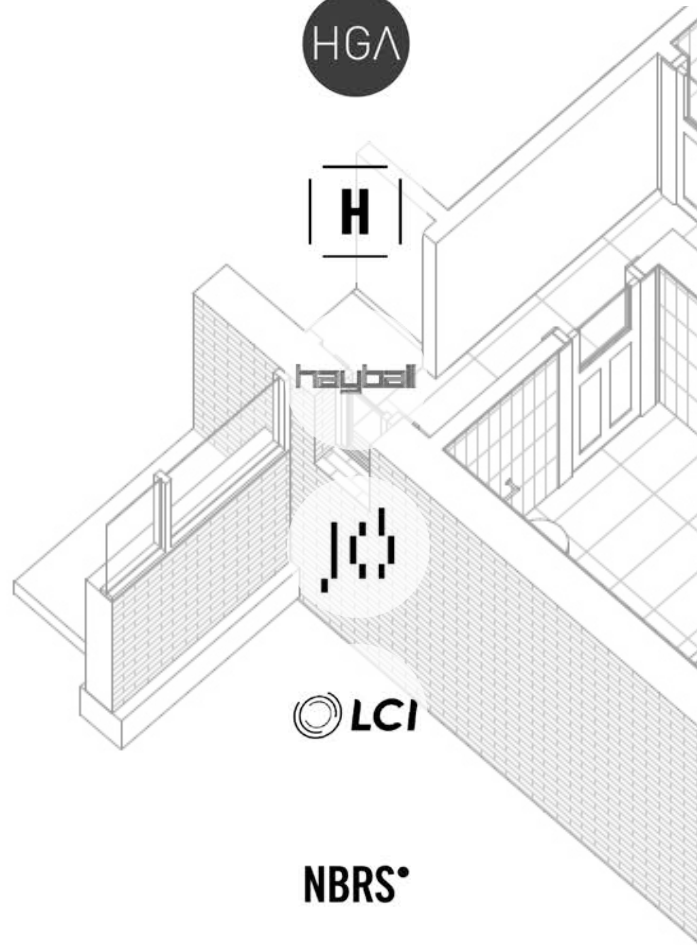

SUMMARY OF PROJECTS: 2022–2023

9 PROJECTS IN
6 COUNTRIES

AUSTRALIA

PROJECT 1: Women, Children & Young People's Crisis Centre
CLIENT: Good Samaritan Inn
NETWORK PARTNERS: Hayball + LCI + WT Partnership
MELBOURNE, VICTORIA

PROJECT 2: Community Asset Planning
CLIENT: Walhalla Board of Management
NETWORK PARTNERS: Tract
WALHALLA, VICTORIA

PROJECT 3: Indigenous Garden
CLIENT: Carlton Neighbourhood Learning Centre
NETWORK PARTNERS: Tract
CARLTON NORTH, VICTORIA

FIJI

PROJECT 4: Women's Resource Centre Stage 2
CLIENT: SVTC
NETWORK PARTNERS: AJ+C
SAVUSAVU, FIJI

PROJECT 5: Village Relocation
CLIENT: Vunivau Village
NETWORK PARTNERS: Hassell
LABASA, FIJI

BHUTAN

PROJECT 6: School Kitchens & Stores
CLIENT: World Food Programme
PARTNERS: Buro Architects
BHUTAN

INDIA

PROJECT 7: Home of Hope Special Needs Orphanage - Fitout
CLIENT: One Life to Love
NETWORK PARTNERS: NBRS Architecture
NEW DELHI, INDIA

AFGHANISTAN

PROJECT 8: Women's Workshop, Training & Learning Centre
CLIENT: Ejaad Afghanistan
NETWORK PARTNERS: SJB Architects
KABUL, AFGHANISTAN

PAPUA NEW GUINEA

PROJECT 9: Komiamp Hospital
CLIENT: Enga Baptist Health Services
PARTNERS: Engineers Without Borders, Nettleton Tribe Architects, Carmen Surveyors, Lilian Arli, Catherine Love and Vicki Leo
KOMPIAM, PAPUA NEW GUINEA

LOCAL PROJECTS



GOOD SAMARITAN INN

Women, Children & Young People's Crisis Centre

Design and documentation a new multi-purpose garden pavilion and Crisis Centre. Delivery and installation of the centre is anticipated in early 2023. (AWF with Hayball, LCI & WT Partnership)



LOCAL PROJECTS

WALHALLA, VIC

WALHALLA Community Asset Planning

AWF conducted an on-site multi day charrette workshop with members of the Walhalla Board of Management and community representatives to explore the potential for managed Crown assets to benefit the wider community. (AWF with Tract Consulting)



LOCAL PROJECTS



CARLTON NORTH LEARNING CENTRE — Indigenous Garden

The indigenous garden was officially opened in November 2022. The design is a peaceful gathering place where people from diverse backgrounds can learn about First Nations food, tools, and culture. (AWF with Tract Consulting, Gunditjmara designer Caitlin Harradine and the Wirundjeri Tribal Council)

INTERNATIONAL PROJECTS

CWRC Women's Resource Centre Stage 2, Fiji

The CWRC Great Hall Building was completed in 2020 and has become the base for community activities run by the Rural Women of Cakaudrove. A project to develop plans for Stage 2 of the Centre was presented to an Australian Government delegation in Fiji in July 2022. (AWF with Allen Jack + Cottier Architects)



INTERNATIONAL PROJECTS



VUNIVAU Village Relocation, Fiji

Vunivau village can be inundated by up to two metres above the village ground and cut off from the road to Labasa during periods of heavy rain and high tide. We are working together with the people of Vunivau to formulate an urban design strategy and housing typologies for them and other Fijian villages forced to relocate due to rising flood and storm surge exacerbated by climate change. (AWF with Hassell)

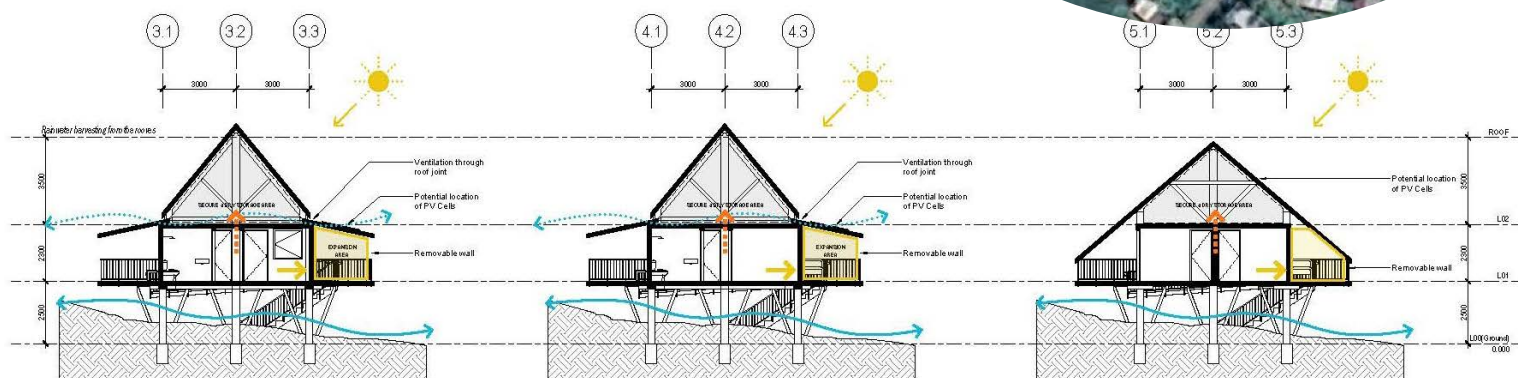

INTERNATIONAL PROJECTS

BHUTAN School Kitchens and Stores

We are working with the Bhutanese Ministry of Education and the World Food Programme to make school kitchen and store designs more efficient, more hygienic, and more sustainable. The Bhutanese Ministry of Education's Health and Nutrition Division provides at least one meal per day to 60% of Bhutan's school children. Many of the existing kitchens and stores are rudimentary, cook with wood-burning stoves, and have unhygienic food preparation areas and insecure stores that lead to food waste and spoilage. (AWF with Buro Architects)



INTERNATIONAL PROJECTS

ONE LIFE TO LOVE

Home of Hope Orphanage,
New Delhi, India

We are helping One Life to Love design facilities to house an orphanage for 10 boys, a Day Care program providing education, nutrition, healthcare & support for up to 50 street children, a girl's education program including library and computer lab, and facilities for physical therapy in a rented building. (AWF with NBR Architecture)



INTERNATIONAL PROJECTS



EJAAD Workshop and Learning Centre, Afghanistan

Construction work on Ejaad's Workshop and Learning Centre is almost complete. The centre combines spaces for craft workshops, literacy and technology classrooms, a rooftop terrace, a small kitchen, and a library. Ejaad is an embroidery and educational project fostering social change for Afghan women through craft. (AWF with Ejaad and SJB Architects)

INTERNATIONAL PROJECTS

KOMPIAM HOSPITAL Papua New Guinea

Development of a facility that provides critical health services in the remote north of Papua New Guinea's Enga Province, an area listed as one of the most disadvantaged in PNG. The hospital's Clinical Services Wing opened in June 2022, 15 years after AWF's first site visit.

[AWF with Enga Baptist Health Services, the Enga Provincial Government, Engineers Without Borders, Nettleton Tribe Architects, Carmen Surveyors and project/masterplan architects Lilian Arli, Catherine Love and Vicki Leo]



AWF NETWORK PARTNERS



AWF NETWORK PARTNERS include architects, landscape architects, urban planners, engineers, quantity surveyors and other land and property specialists. All AWF Network partners are highly qualified professional organisations with extensive project portfolios in Australia and overseas.

The generous support of the Network Partners enables AWF to continue delivering humanitarian projects in a sustainable way through their financial and in-service support.





ARCHITECTS
WITHOUT
FRONTIERS

2021-2022 FINANCIAL REPORT





ARCHITECTS WITHOUT FRONTIERS | ABN 39 109 129 679
PROFIT AND LOSS STATEMENT
FOR THE YEAR ENDED 30 JUNE 2022

	2022	2021
	A\$	A\$
INCOME		
Donations	36,219	45,674
Supporter network membership fees + contributions	74,000	64,600
Interest received	699	410
Project settlement	10,000	-
Government support (COVID-19)	-	43,900
	120,918	154,584
LESS EXPENDITURE		
Accountancy and audit fees	990	990
Administration	399	545
Bank charges	59	59
Catering coffee/meetings	939	173
Graphics + communication services	704	1,538
Computer + IT	1,942	1,431
Contractors	47,093	56,690
Depreciation		298
Insurance	5,016	4,800
Marketing		4,146
Printing + stationery	239	-
Salaries + wages	26,915	26,700
Salaries + wages — annual leave provision		(1,789)
Superannuation contributions — employees	1,795	2,075
Superannuation contributions — contractors	2,416	5,268
Travel + accommodation	3,373	3,285
Workcover	218	204
	92,098	106,413
NET OPERATING SURPLUS	28,820	48,171
PROJECTS		
Project funding recognised	106,666	38,000
Project expenditure	-106,666	(38,232)
PROJECT SURPLUS (DEFICIT)	0	(232)
NET SURPLUS (DEFICIT)	28,820	47,939
Retained profits at the beginning of the financial year	169,268	121,329
TOTAL AVAILABLE FOR APPROPRIATION	198,088	169,268
ACCUMULATED SURPLUSES AT THE END OF THE FINANCIAL YEAR	198,088	169,268



6 RIVERSIDE QUAY
MELBOURNE VIC 3000

INFO@ARCHITECTSWITHOUTFRONTIERS.COM.AU
ARCHITECTSWITHOUTFRONTIERS.COM.AU

 @AWF_AUS
 ARCHITECTSWITHOUTFRONTIERS
 ARCHITECTS WITHOUT FRONTIERS

AWF CHAIR

Phillip Greenham

EXECUTIVE DIRECTOR

Esther Charlesworth AM

BOARD MEMBERS

Leeanne Marshall
Norman O'Day
Paul O'Connor
Robert Stent

PATRONS

The Hon. Gareth Evans QC, AO
Phillip Adams AO

AMBASSADORS

Peter Maddison
John Gollings

AWF NETWORK

Allen Jack + Cottier
Clarke Hopkins Clarke
Harley Graham Architects
Hassell
Hayball
JCB Architects
LCI
NBRS Architecture
SJB
Tract Consultants
WT Partnership

COORDINATOR

Teresa O'Shannassy

PROJECT COORDINATOR

Sarah Schoffel
James Harley

FINANCE ADMINISTRATOR

Daniel Conquest

TRANSFORMING
LIVES THROUGH
DESIGN